

DStwo, The Second Generation SuperCard Flashcard, Took the SuperCard team one year of hard work to finish. It's the first Flashcard with a Built-In CPU in the world. It not only includes all the features of the DSone, but it uses its CPU to provide more Powerful functions. The flashcard has GBA/SNES Emulators, and Real-Time Functionality. It begins with DStwo. It's the time to go beyond the DS

Fast Start up:



Step 1	Download the OS from www.supercard.sc .
Step 2	Unzip and copy the system folder _dstwo to the root of microSD.
Step 3	Copy the game files to the microSD, insert the microSD into DSTWO.

Hotkey

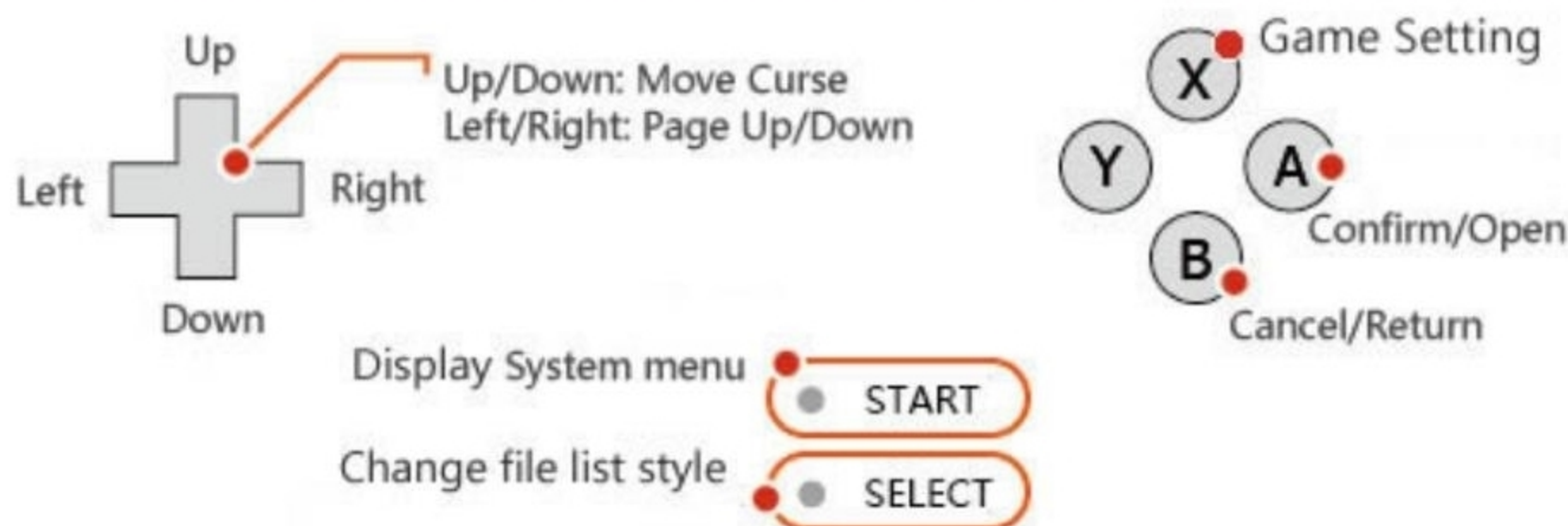

Basic Operation

Up/Down/Left/Right	Move cursor
X	Game setting
A/B	A/B Open / Close File
START	calling System menu
Select	Mode set

Main menu instruction

File Operation	File Management System (Copy, Paste, Cut and Delete).
Skin	Setting skin.
Language	English/Chinese/French/Italian/Japanese/Spanish/German/Korean
System	display/brightness/Hot Keys
Help	using help

Enhancements (Hotkey in game: L+R+Start)



DSTWO Customizable Desktop

It's very easy. Just copy the homebrew main program (*.nds) to the _dstwoplug folder. In addition to some homebrew, there is a folder outside the main program (such as moonshell), copy the folder to the root directory of MicroSD card.

- Want to make a look good icon?
1. Make a 16-bit 40X42 bmp picture, with the same name as the homebrew. For example, homebrew.nds needs a picture file named homebrew.bmp.
 2. Create a *.txt file and then enter the following text:
[Plug setting]
Icon = fat1: / _dstwoplug /homebrew software name.bmp
Name = homebrew software name,
 3. save the txt file and then rename the *.txt file to *.ini. For example, homebrew.nds need a *.ini file named homebrew.ini.
 4. Finally to copy the *.bmp file and *.ini files to the _dstwoplug folder, restart the "DSTWO Desktop" you can see the new icon added to the list